

INDEX - HYDRAULIC TOOLS

HWC & HSWC Range

Hammer blow & single acting wire rope cutters

Page
52

HWRC Range

Double acting wire rope cutters

Page
53

HCC Range

Chain cutters

Page
54

CT & HCH Range

Cutters

Page
55

SC Range

Self-contained cable crimping tools

Page
56

CH Range

Cable crimping tools

Page
57

HHP & HKP Range

Hole punchers

Page
58

NS & HMNS Range

Nut splitters

Page
59

HFS Range

Hydraulic flange spreaders

Page
60

MFS Range

Mechanical flange spreaders

Page
61

JS & SJS Range

Jaw spreaders

Page
62

HPB Range

Bench presses

Page
63

HPF Range

Workshop floor presses

Pages
64 - 65

Moving skates

Multi purpose & heavy duty moving skates

Pages
66 - 68

HWC - HAMMER BLOW WIRE ROPE AND CABLE CUTTERS



Highly cost efficient impact design

Cutting capacity up to 38mm diameter wire rope

Portable and lightweight

The Hi-Force HWC range of highly cost effective cutters are manufactured from high quality, shock resistant, ductile iron and are fitted with replaceable cutting blades made from tool steel. The cutting blades are retained in the housing at the moment of impact, ensuring absolute safety. These cutters offer a considerable time saving over conventional axe, chisel and hacksaw methods.

Model number	Cutting capacity		Weight kg
	Wire rope Ø mm	Electric cable mcm	
HWC90	25	250	3.2
HWC91	27	300	7.0
HWC92	38	750	13.0

Dimensions in mm	
Height	Base diameter
168	89
187	162
241	200

HSWC - SELF-CONTAINED HYDRAULIC WIRE ROPE CUTTERS

H



Cutting capacities from 19 to 44mm diameter

Strong rigid steel construction

Easy to use with minimum operator effort

The Hi-Force range of self-contained portable hydraulic wire rope and cable cutters comprises of three models with cutting capacities from 19 to 44mm diameter. Approved and specified by many major industries throughout the world, these high quality cutters are precision engineered to give a good, clean cut with minimum effort, time after time. The self-contained design of the cutter enables easy transportation to the job site with minimum of fuss. The shear blades are manufactured using high quality tool steel, which is heat treated and ground to very tight tolerances, ensuring superior performance and long-life. Customers include wire rope manufacturers, earthmoving and construction contractors, rigging shops, elevator manufacturers and repairers and many others. Also suitable for use under water by divers.

Model number	Cutting capacity wire rope mm Ø	Weight kg
HSWC19	19	9.5
HSWC28	28	15.5
HSWC44	44	30.0

Dimensions in mm		
Length	Width	Height
305	92	153
355	105	178
470	127	203

HWRC - DOUBLE ACTING WIRE ROPE CUTTERS



Working pressure 700 Bar

Double acting design

Smooth guillotine cutting action



Hand and powered pumps suitable for these cutters are detailed on pages 21 to 32.

- >> Cuts high tensile locked coil wire rope and steel bar
- >> Cutting capacities from 38 to 90mm diameter wire rope
- >> Cutting capacities from 25 to 50mm diameter steel bar

The HWRC range of hydraulic cutters is specifically designed and manufactured for cutting high tensile locked coil wire rope and solid steel bar. Maximum cutting capacities range from 38 to 90mm diameter wire rope and 25 to 50mm diameter 28 tonnes tensile solid steel bar. All models incorporate a double acting hydraulic cylinder, suitable for working pressures up to 700 bar and an open jaw design cutting head (see pictures below) for easy access to the material to be cut. Cutting blades and jaws are manufactured from specially toughened high tensile steel and the smooth guillotine action of the cutter greatly reduces the risk of blade jamming.

H



Step 1:

To open the cutter, swivel cutting head forward.



Step 2:

Position material to be cut in the cutting head slot.



Step 3:

Close the cutting head by swivelling it back to its original position and secure behind the latch.

Model number	Cutting capacity		Oil capacity cm ³	Weight kg
	Wire rope mm Ø	Solid steel bar mm Ø		
HWRC1115	38	25	267	26
HWRC1125	63	50	874	65
HWRC1136	90	50	1242	75

Dimensions in mm		
Length	Width	Height
305	195	254
419	245	330
495	245	356

HCC - CHAIN CUTTERS



Working pressure 700 Bar

Single acting design

Fitted with locking guard

- >> Cuts high tensile grade 80 chain and reinforcing bar
- >> Cutting capacities from 26 to 46mm diameter
- >> Overload protection valve fitted as standard

The HCC range of hydraulic cutters is specifically designed and manufactured for cutting high tensile chain and reinforcing bar. The easily replaceable cutter blades are manufactured from specially toughened high tensile steel and the choice of models available offer maximum cutting capacities up to 46mm diameter. All models are suitable for working pressures up to 700 Bar and incorporate a single acting cylinder fitted with a powerful piston retraction spring. The swivel action design of the locking safety guard (see pictures below) allows easy access for the material to be cut.

H



Picture 1:

HCC26 cutter shown with swivel action locking & safety guard opened.



Picture 2:

HCC26 cutter shown with swivel action locking & safety guard closed.



Hand and powered pumps suitable for these cutters are detailed on pages 21 to 32.

Model number	Cutting capacity mm Ø	Cutting force tonnes	Oil capacity cm ³	Weight kg
HCC26	26	72	276	23
HCC34	34	100	492	40
HCC46	46	140	980	72

Dimensions in mm		
Length	Width	Height
440	180	180
410	460	250
565	635	345

CT - SELF CONTAINED HYDRAULIC CUTTERS

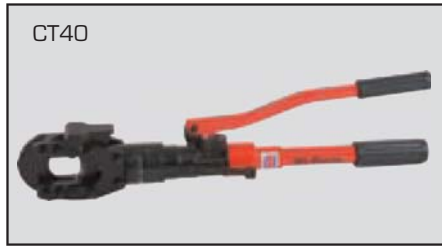

CT40

Cutting capacity up to 40mm diameter

Cuts a wide variety of materials

Self-contained hydraulic design

The CT self-contained hydraulic cutter range offers a choice of 2 models with cutting capacities up to 25mm steel wire rope and 40mm cable. These versatile cutters are suitable for cutting wire rope, round bar, wire strands and electrical cable.

Maximum diameter cutting capacity in mm :

Model number	Cutting force tonnes	Length mm	Weight kg	WIRE ROPE				ROUND BAR				WIRE STRANDS					CABLE		
				6X7 Hempcore	6X12 Hempcore	6X19 Hempcore	6X25 Hempcore	Soft copper bar	Soft aluminium bar	Soft steel bar	Reinforced bar	Bare copper strands	Bare aluminium strands	ACSR	1x7 Guy steel wire strands	1x19 Guy steel wire strands	Telephone cable CCP	Lead sheathed cable	Underground cable
CT20	6	390	2.8	20	20	20		20	20	16	13	20	20	20	15	16	20	20	20
CT40	6	630	6.0	20	25	25		25	22	16	13	40	40	40	15	20	*	*	40

* Not suitable

HCH - HYDRAULIC CUTTER HEADS



HCH40

Cutting capacity up to 120mm diameter

Working pressure 700 Bar

Compact and lightweight

The HCH cutter head range cuts a wide range of materials and offers 2 models with similar features to the CT range of self-contained cutters. A comprehensive range of suitable manually operated and powered hydraulic pumps suitable for use with Hi-Force HCH cutters is detailed on pages 21 to 32.

Maximum diameter cutting capacity in mm :

Model number	Cutting force tonnes	Length mm	Weight kg	WIRE ROPE				ROUND BAR				WIRE STRANDS					CABLE		
				6X7 Hempcore	6X12 Hempcore	6X19 Hempcore	6X25 Hempcore	Soft copper bar	Soft aluminium bar	Soft steel bar	Reinforced bar	Bare copper strands	Bare aluminium strands	ACSR	1x7 Guy steel wire strands	1x19 Guy steel wire strands	Telephone cable CCP	Lead sheathed cable	Underground cable
HCH40	6	247	2.8	20	25	25		25	22	16	13	32	32	40	15	20	*	*	*
HCH120	15	600	14.0	25	30	30		35	28	22	*	125	125	125	15	20	*	*	125

* Not suitable

SC - SELF-CONTAINED CABLE CRIMPING TOOLS

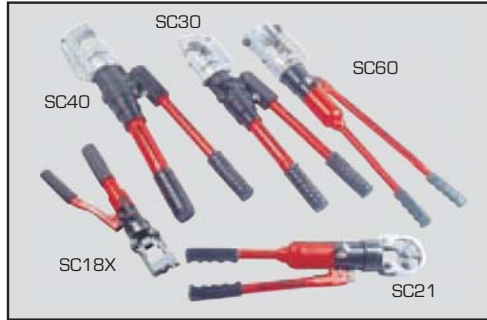

Choice of 7 available models

Supplied complete with die sets

Automatic pressure release valve

The SC self-contained hydraulic cable crimping tool range offers 7 models with a choice of open “C” jaw or parallel guide design. All models are fitted with an automatic pressure release valve and are supplied complete with standard die sets and a carrying case. Models with 180° rotating head are designed for easy access into confined spaces.

- >> Models SC30, SC40 & SC60 are suitable for crimping connectors from 35 to 630mm²
- >> Models SC15, SC18X, SC21 & SC32 are suitable for crimping non-insulated terminals from 10 to 400mm²
- >> Models SC30 & SC40 incorporate 180° rotating head



H

Model number	Output tonnes	C - Jaw opening	Applicable range DIN mm ²	Standard dies mm ²	Length mm	Weight kg
SC15	10	not applicable	16-185	With die (3pcs) 16-25, 35-70, 70-185 Female die (1pc) 16, 25-35, 50-60, 70-120, 150-185	528	5.2
SC21	10	not applicable	25-240	With die (4pcs) 25, 35-50, 70-185, 240 Female die (1pc) 25-35, 50-70, 95-120, 150-185, 240	528	5.2
SC30	12	30 mm	35-400	With die 35, 50, 70, 95, 120, 150, 185, 240, 300, 400	610	6.3
SC32	18	not applicable	16-400	With die (4pcs) 16, 25-35, 50-120, 150-400 Female die (8pcs) 16-25, 35-70, 95-120, 150, 185, 240, 300, 400	650	6.2
SC40	12	38 mm	35-400	With die 35, 50, 70, 95, 120, 150, 185, 240, 300, 400	636	7.7
SC60	18	not applicable	35-630	With die 35, 50, 70, 95, 120, 150, 185, 240, 300, 400, 500, 630	650	6.5
SC18X	6	not applicable	10-185	With die 10-16, 25-35, 50-70, 95-120, 150, 185	370	2.0

Note : Models SC15, SC21 & SC32 are supplied with single indent dies, all other models are supplied with hexagonal dies.

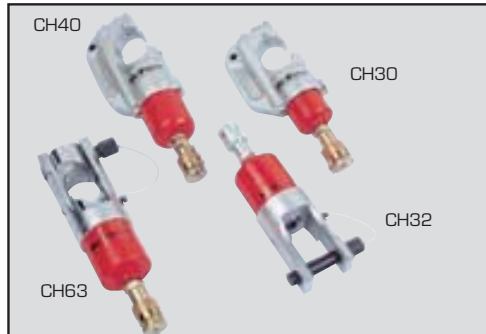

Choice of 7 available models

Supplied complete with die sets

Working pressure 700 Bar

The CH hydraulic cable crimping tool range offers 7 models with a choice of open “C” jaw or parallel guide design. All models are supplied complete with standard die sets and a carrying case. Models with 180° rotating head are designed for easy access into confined spaces. Pump units include HP227FPC foot operated pump set which includes elbow fitting, gauge, gauge block, 3 metre hose and male coupler, as shown below. All models, excluding HC1000, are available as a complete kit, comprising of HP227FPC, MB1 metal storage case and selected crimping tool with die sets.

- >> Models CH30, CH40 & CH63 suitable for crimping connectors up to 630mm²
- >> Models CH21 & CH32 are suitable for crimping non-insulated terminals up to 400mm²
- >> Models CH80 & CH1000 are suitable for crimping distribution and transmission lines up to 1000mm²



Hi-Force foot operated manual pump unit complete with accessories. For pump specifications, please see page 23, model HP227FP.



Model number	Output tonnes	C-Jaw opening	Applicable range DIN mm ²	Standard dies mm ²	Length mm	Weight kg
CH21	10	not applicable	16-240	With die (4pcs) 16-25, 35-70, 70-185, 240 Female die(1pc) 25-35, 50-70, 95-120, 150-185, 240	210	3.0
CH30	12	30 mm	35-400	With die 35, 50, 70, 95, 120, 150, 185, 240, 300, 400	220	4.0
CH32	18	not applicable	16-400	With die (4pcs) 16, 25-35, 50-120, 150-400 Female die(8pcs) 16-25, 35-70, 95-120, 150, 185, 240, 300, 400	210	3.6
CH40	12	38 mm	35-400	With die 35, 50, 70, 95, 120, 150, 185, 240, 300, 400	245	4.8
CH63	18	not applicable	35-630	With die 35, 50, 70, 95, 120, 150, 185, 240, 300, 400, 500, 630	240	4.8
CH80	15	50 mm	35-630	With die 35, 50, 70, 95, 120, 150, 185, 240, 300, 400, 500, 630	300	7.0
CH1000	50	not applicable	500-1000	With die 500, 630, 800, 1000	420	38.0

Note : Models CH21 & CH32 supplied with single indent dies, all other models supplied with hexagon dies.

HHP - HOLE PUNCHER



Punching force 30 tonnes

Throat depth 70mm

Working pressure 700 Bar

The HHP hole puncher delivers 30 tonnes of full punching power and is capable of punching up to 20.5mm diameter holes in 10mm thick steel plates. Designed and manufactured with a spring assisted return piston for easy removal from the steel plate and an integral positioning and carrying handle. Unit supplied with standard set of four punch and dies in a handy storage and carrying case. See pages 21 to 32 for detailed information on suitable pumps for use with the HHP30 hydraulic hole puncher.



Model number	Maximum force tonnes	Throat depth mm	Punch capacity (mm) Steel plate	Hole punch diameter	Standard punch/die sets included mm	Recommended pump & hose Manually operated	Pneumatically operated	Weight excl. pump kg
HHP30	30	70	10.0	up to 20.5	10.5, 13.5 17.5, 20.5	HP227 complete with HC3 3m hose	AHP1120 complete with HC3 3m hose	19.8

Note: pump supplied separately

HKP - KNOCK OUT PUNCHER

H



Capacity 10 tonnes

Spring return hydraulic cylinder

Working pressure 700 Bar

The HKP knock out puncher is supplied as a complete set and includes all standard sizes of punches/dies, manually operated pump and hose complete with quick release coupler. Ideal for on-site hole punching in electric control panels and metal plates.

- >> Supplied complete with carrying case
- >> Ideal for punching holes in electric control panels & steel plates

- >> Also included in HKP10 set :
Manually operated pump HP110 (see page 23)
Hose and coupling assy HC2 (see page 36)

Model number	Maximum force tonnes	Plate capacity (mm) Stainless steel	Mild steel	Weight excl. pump kg	Standard punch/die set (10 sizes) included										
HKP10	10	1.6	3.2	35.8	Hole Ø (mm)	: 21.8	27.6	34.1	42.7	48.7	60.5	76.1	88.9	102.8	115.5
					Conduit Ø (inch):	½"	¾"	1"	1¼"	1½"	2"	2½"	3"	3½"	4"



Capacities from 10 to 75mm AF

Working pressure 700 Bar

Compact & easy to use

The NS & HMNS range of hydraulic nut splitters offers a choice of 10 models suitable for hexagon nut AF sizes from 10 to 75mm [M6 to M48 bolt sizes]. Designed to easily split corroded nuts up to Rc44 hardness, Hi-Force nut splitters offer the ideal “cold cut” solution for removing worn and corroded fasteners, especially in applications where “hot work” permits are not allowed. All NS models are supplied fitted with a unique 360° positional swivel coupling for easy adjustment and fitment in confined spaces. Suitable pumps for the NS models are detailed on pages 21 to 32. The HMNS models incorporate an integral hydraulic pump with multi-positional lever for even greater versatility. All models have an angled body design to provide the necessary clearance on flanges and flat surfaces, and the splitter blades are manufactured from high quality tool steel which must be re-sharpened or replaced, as and when required.

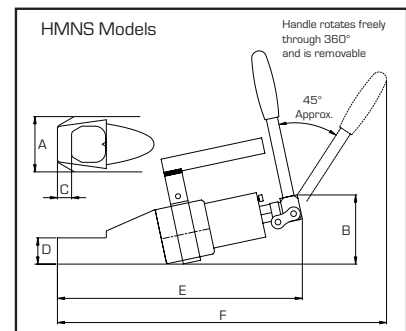
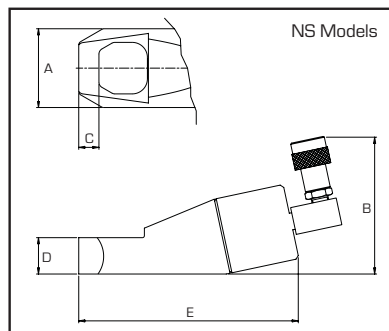

NS hydraulic nut splitters

Model number	Hexagon AF sizes mm	Thread sizes mm	Weight kg
NS75	10 - 19	M6 - M12	1.5
NS95	19 - 24	M12 - M16	2.3
NS126	24 - 32	M16 - M22	4.0
NS161	32 - 41	M22 - M27	6.5
NS197	41 - 50	M27 - M33	10.6
NS236	50 - 60	M33 - M39	14.6
NS296	60 - 75	M39 - M48	33.5

Dimensions in mm					
A	B	C	D	E	F
40	113	7.5	19.5	121	30
54	119	10.0	24.0	150	41
64	128	12.5	30.0	188	52
78	136	20.0	37.0	217	69
94	145	21.0	45.0	271	78
105	155	24.5	54.0	313	91
156	177	27.0	75.0	356	110

HMNS hydraulic nut splitters with integral manually operated pump

Model number	Hexagon AF sizes mm	Thread sizes mm	Weight kg
HMNS126	24 - 32	M16 - M22	5.5
HMNS161	32 - 41	M22 - M27	7.0
HMNS197	41 - 50	M27 - M33	13.4

Dimensions in mm					
A	B	C	D	E	F
64	93	12.5	30.0	328	447
78	103	20.0	37.0	357	465
94	120	21.0	45.0	410	540



HFS - HYDRAULIC FLANGE SPREADERS



Capacities from 4.5 to 10 tonnes

Working pressure 700 Bar

Supplied in a steel storage & carrying case

HFS hydraulic flange spreaders provide the ideal solution for safely opening pipe flanges in the marine and oil & gas industry. Available in capacities from 0 - 4.5 tonnes and 0 - 10 tonnes, both models offer the user the capability of opening flanges up to 92mm thick. Operated with a standard Hi-Force hydraulic pump (full specifications see page 23) and connecting hose (see page 36) and supplied in a handy steel storage and carrying case, Hi-Force hydraulic flange spreaders can be operated individually, or as a pair when opening large flanges. With Hi-Force flange spreaders you are only minutes away from safely opening the toughest flanges without the risk of sparks caused by hammer blows, chisels and flying wedges.

- >> Supplied complete with manually operated pump and hose assembly
- >> Optional wedge available for larger separation
- >> Suitable for stud bolt sizes up to 41 mm

H

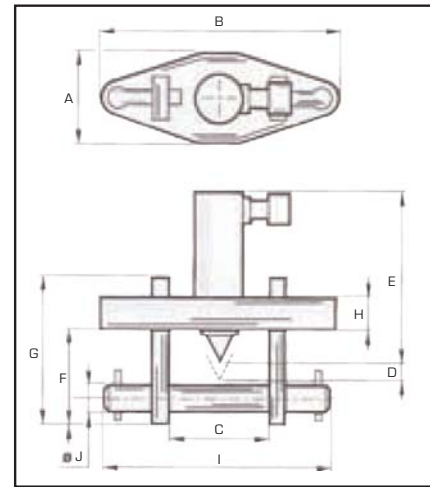
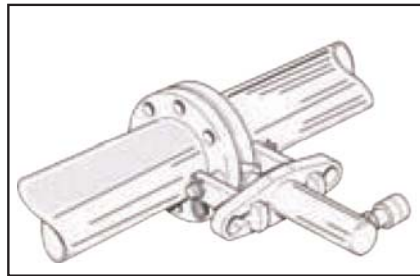

Specifications :

Model number	Capacity tonnes	Stroke mm	Oil capacity cm ³	Max. flange thickness mm	Stud size mm	Standard wedge mm	Optional wedge mm	Weight kg
HFS50	4.5	75	48	2 x 57	19 - 29	3 - 29	30 - 56	22.5
HFS100	10	56	81	2 x 92	32 - 41	3 - 29	30 - 56	29.1

Note: HFS flange spreaders are also available as spreader only (without pump and hose assembly). Please add suffix 'H' to model number if spreader only is required.

Dimensions in mm :

Model number	A	B	C min	C max	D	E	F	G	H	I	J
HFS50	76	210	61	155	10	192	69	129	25	206	18
HFS100	108	290	61	224	30	165	89	178	38	273	31

MFS - MECHANICAL FLANGE SPREADERS



Suitable for bolt diameters up to 31mm

Maximum spread 231mm

No external power source required

The MFS range of mechanical flange spreaders comprises of 6 models, each offering a safe and economical way to open flanges without the risk of sparks. The threaded spindle can be operated using a standard spanner, allowing the user to apply a controlled force without damaging the flange. Due to the mechanical design of these flange spreaders, no external power source is needed and therefore, they can be used anywhere on-site.

- >> Choice of six models available
- >> Drop forged EN9 spreading wedge
- >> High grade steel construction with high tensile cross bolt

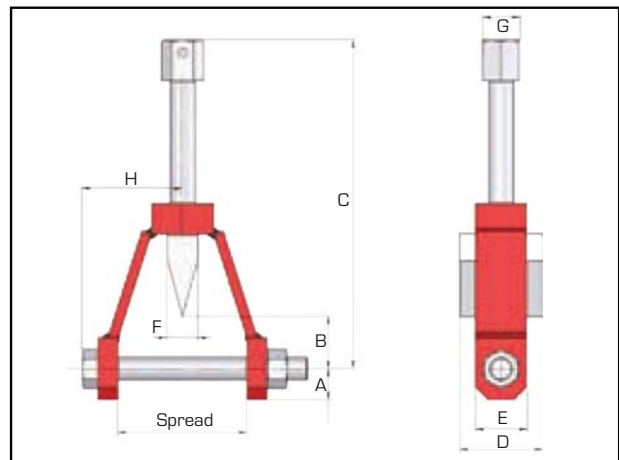

Model number	A	B max.	C min.	C max.	D	E	F	G	H
MFS16	25	28	185	232	65	40	25	30	66
MFS19	30	50	185	254	65	50	25	30	81
MFS22	30	50	247	318	80	50	30	36	97
MFS25	30	85	247	353	80	50	30	36	113
MFS28	30	80	275	382	90	60	40	46	130
MFS31	32	84	275	385	90	60	40	46	157

Model number	Maximum bolt diameter		Maximum spread		Weight kg
	mm	inch	mm	inch	
MFS16	16	5/8"	70	2 3/4"	2.2
MFS19	19	3/4"	95	3 3/4"	2.7
MFS22	22	7/8"	124	4 7/8"	4.1
MFS25	25	1"	155	6 1/8"	6.4
MFS28	28	1 1/8"	181	7 1/8"	8.2
MFS31	31	1 1/4"	231	9 1/8"	9.6



Capacities up to 0.9 tonnes

Working pressure 700 Bar

Maximum spread 292mm

The JS range of hydraulic spreaders offers the ideal solution for spreading, wedging and prising operations in a wide variety of industrial applications. With a choice of two models available, Hi-Force hydraulic jaw spreaders are of compact, low weight, spring assisted return design and operate within a minimum space of 9.7mm up to a maximum spread of 292mm. With a powerful spreading capacity of up to 0.9 tonnes available, Hi-Force hydraulic jaw spreaders are ideal for use in applications where maximum force is required in a confined space. All models are manufactured from high-strength steel, are suitable for operating at 700 bar working pressure and are supplied complete with quick release female half coupling for easy attachment to a Hi-Force manually operated or powered hydraulic pump unit.

- >> Choice of three models
- >> Single acting, spring assisted return
- >> Compact & lightweight design

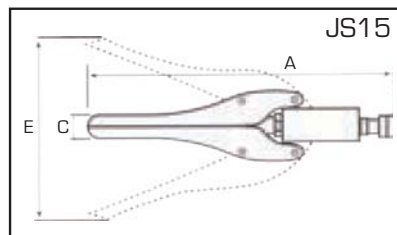
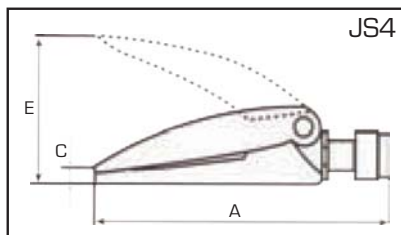

Model number	Capacity tonnes	Oil capacity cm ³	Weight kg
JS4	0.90	10.0	2.2
JS15	0.68	64.1	11.3

Dimensions in mm					
A	B	C	D	E	F
223	-	9.7	-	94	-
550	-	32.0	-	292	-



Capacity 10 tonnes

Stroke lengths from 150 to 250mm

Working pressure 700 Bar

The HPB range of hydraulic bench presses offers 6 models available with a choice of manually operated hand or foot pumps or air powered foot pumps. The compact design enables easy positioning of the press frame on a workshop bench and the easily detachable hydraulic components, make these presses an extremely versatile hydraulic tool. Also suitable for mounting in small vehicles for on-site testing applications.



See pages 64 - 65 for our comprehensive range of workshop floor presses up to 100 tonnes capacity

- >> Choice of 6 models with manually operated or air powered pumps
- >> Detachable hydraulics for use in other applications
- >> Horizontally adjustable cylinder block
- >> Vertical or horizontal operation
- >> Supplied complete with pump, hose, gauge, gauge block and quick release couplers

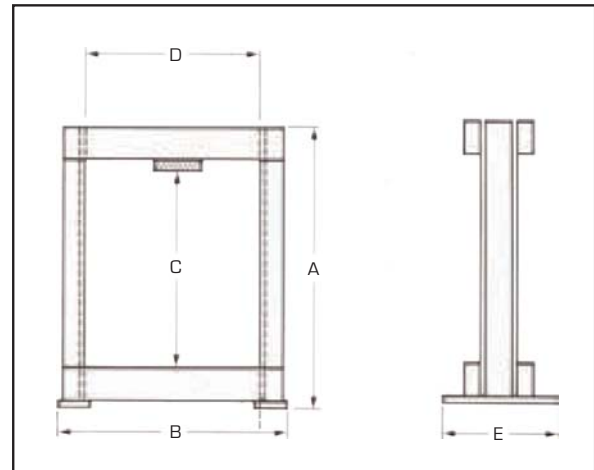

H

Model number	Capacity tonnes	Stroke mm	Pump model no.	Pump operation	Weight kg
HPB1020	10	250	HP110	hand operated	78
HPB1020F	10	250	HP227FP	foot operated	83
HPB1026	10	150	HP110	hand operated	77
HPB1026F	10	150	HP227FP	foot operated	82
HPB1030	10	250	AHP1120	air powered	78
HPB1036	10	150	AHP1120	air powered	77

Dimensions in mm				
A	B	C	D	E
675	545	478	394	280
675	545	478	394	280
675	545	478	394	280
675	545	478	394	280
675	545	478	394	280
675	545	478	394	280



HPF10042

Capacities from 10 to 100 tonnes

Stroke length 250 or 330mm

Working pressure 700 Bar

- >> Choice of manual, air or electric powered pumps
- >> Adjustable work table
- >> Supplied complete with pressure gauge
- >> Other configurations available on request



For further product details, frame dimensions and optional available accessories, please see opposite page

Model number	Capacity tonnes	Stroke mm	Cylinder model no. ¹	Cylinder principle	Pump model no. ²	Pump operation	Weight kg
HPF1020	10	250	HSS1010	single acting	HP110	manual	95
HPF1030	10	250	HSS1010	single acting	AHP1120	air driven 7 bar	85
HPF2520	25	250	HSS2510	single acting	HP227	manual	145
HPF2530	25	250	HSS2510	single acting	AHP1120	air driven 7 bar	138
HPF2541	25	250	HSS2510	single acting	HEP103341	electric driven 110 V	160
HPF2542	25	250	HSS2510	single acting	HEP103342	electric driven 240 V	160
HPF2544	25	250	HSS2510	single acting	HEP207314	electric driven 415 V	160
HPF5020S	50	330	HSS5013	single acting	HP257	manual	470
HPF5020D	50	330	HDA5013	double acting	HP257D	manual	500
HPF5030S	50	330	HSS5013	single acting	AHP1121	air driven 7 bar	505
HPF5030D	50	330	HDA5013	double acting	AHP1141	air driven 7 bar	505
HPF5041S	50	330	HSS5013	single acting	HEP207311	electric driven 110 V	505
HPF5041D	50	330	HDA5013	double acting	HEP207411	electric driven 110 V	481
HPF5042S	50	330	HSS5013	single acting	HEP207312	electric driven 240 V	512
HPF5042D	50	330	HDA5013	double acting	HEP207412	electric driven 240 V	518
HPF5044S	50	330	HSS5013	single acting	HEP207314	electric driven 415 V	518
HPF5044D	50	330	HDA5013	double acting	HEP207414	electric driven 415 V	518
HPF10020	100	330	HDA10013	double acting	HP235D	manual	1011
HPF10030	100	330	HDA10013	double acting	HAP21042	air driven 7 bar	1029
HPF10041	100	330	HDA10013	double acting	HEP207421	electric driven 110 V	1043
HPF10042	100	330	HDA10013	double acting	HEP207422	electric driven 240 V	1043
HPF10044	100	330	HDA10013	double acting	HEP207424	electric driven 415 V	1043

Notes: ¹) For detailed specification on applicable cylinders, see pages 12-13 for HSS range and page 16 for HDA range.

²) For detailed specification on applicable pumps, see page 23 for HP range, page 25 for HEP range, page 29 for AHP range and page 30 for HAP range.

The HPF range of workshop presses offers a choice of 22 models with either single acting or double acting cylinders and manually operated, air powered or electric powered pumps. All presses incorporate an adjustable work table and dual scale pressure gauge. Factory mounted optional accessories include a mechanical bed winch for easy adjustment of the work table and multi-position V-blocks. All presses are supplied completely assembled, ready for use. Hi-Force workshop presses are manufactured to the highest quality standards, and are suitable for the most demanding jobs.

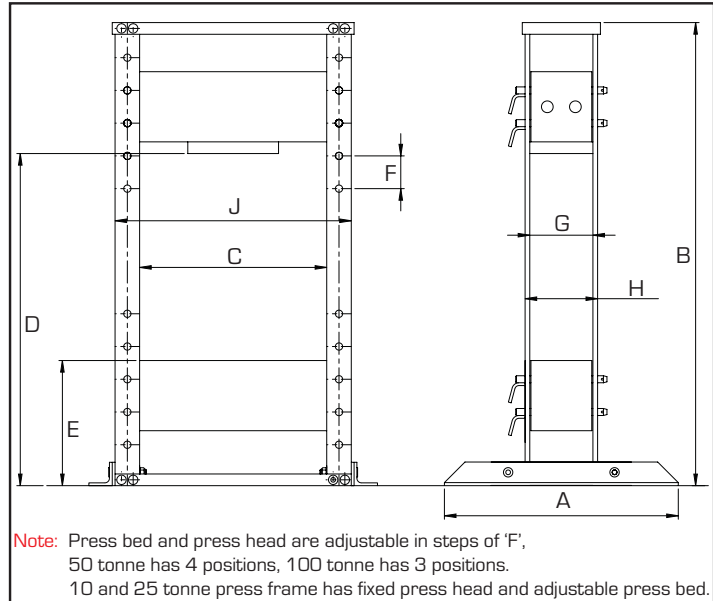

Model number	Capacity tonnes
HPF1000	10
HPF2500	25
HPF5000	50
HPF10000	100

Frame dimensions in mm											
A	B	C	D (min)	D (max)	E(min)	E(max)	F	G	H	J	
742	1448	508	1258	260	1010	150	-	152	660		
742	1448	508	1258	260	1010	150	-	152	660		
1000	2055	800	1140	1560	395	815	140	258	298	1000	
1000	1980	1000	1090	1370	550	830	140	338	388	1240	

Mechanical bed winches



- >> Factory fitted option
- >> Lifts and lowers work table
- >> Available for 50 and 100 tonnes presses

Model number	Applicable for
HBW50	All Hi-Force 50 tonnes workshop presses, HPF range
HBW100	All Hi-Force 100 tonnes workshop presses, HPF range

Multi-position V-blocks

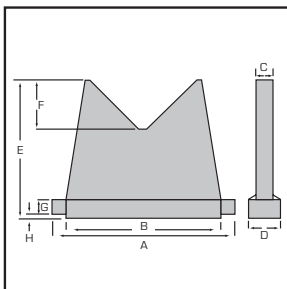

- >> With flat bed and V-shape press surfaces
- >> Available for 10, 25, 50 and 100 tonnes presses

Model number	Cap. per set tonnes	Dimensions in mm							
		A	B	C	D	E	F	G	H
HVB2500	10 - 25	204	154	20	45	155	45	20	8
HVB5000	50	365	265	25	50	190	60	25	10
HVB10000	100	425	325	35	60	265	85	35	10

RSM - NYLON MULTI-ROLLER STEERABLE SKATES

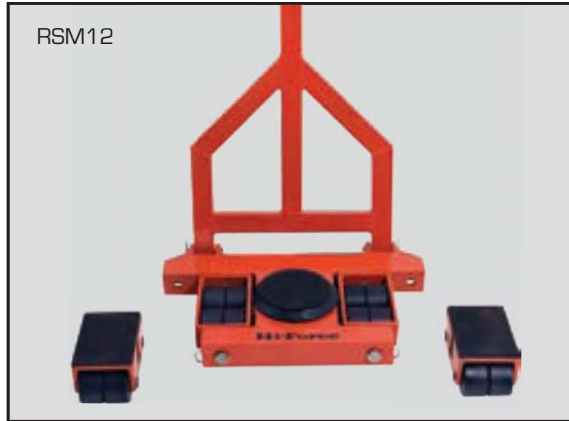

Capacities from 6 to 30 tonnes

Steerable front skate for total control

Low weight, compact size

The RSM nylon multi-roller steerable skate range is ideal for use on tiled floors and is available with capacities from 6 to 30 tonnes. These skates consist of 3 major parts: 1 steerable turntable front skate and 2 adjustable rear skates. This modular design allows the system to be easily assembled and dismantled without the use of tools. All models are fitted with low rolling resistance wheels with ball bearings and non-slip Neoprene pads on each load surface.

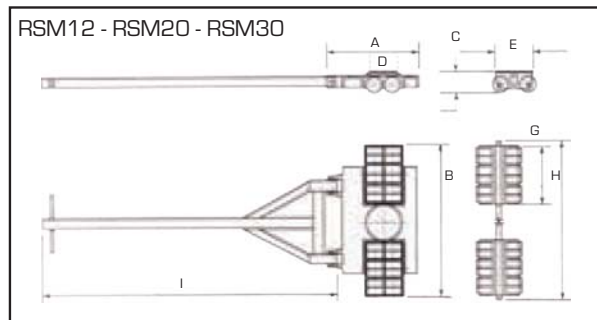
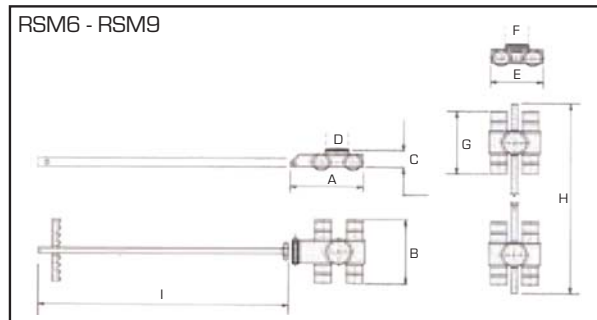

Model number	Capacity per skate set tonnes	No. of wheels front steerable	No. of wheels rear skate	Weight incl. box kg
RSM6	6	4 no. 82 mm x 48 mm	8 no. 82 mm x 48 mm	51
RSM9	9	8 no. 82 mm x 48 mm	16 no. 82 mm x 48 mm	64
RSM12	12	8 no. 82 mm x 48 mm	8 no. 82 mm x 48 mm	95
RSM20	20	16 no. 82 mm x 48 mm	16 no. 82 mm x 48 mm	118
RSM30	30	24 no. 82 mm x 48 mm	24 no. 82 mm x 48 mm	135

Dimensions in mm								
A	B	C	D	E	F	G	H max	I
330	210	109	110	240	110	210	1500	1150
330	310	109	160	240	160	310	1500	1150
413	614	110	190	180	-	130	1500	1500
413	673	110	190	180	-	242	1500	1500
413	990	110	190	188	-	354	1500	1500

RSC & RSS - MULTI-PURPOSE SKATES



Capacities from 5 to 100 tonnes

Available as complete kit or as individual skates

Endless hardened roller chain

The RSC and RSS range of industrial, low profile skates offer the safest, fastest and most economical method of moving heavy equipment. Four models are available with capacities of up to 37.5 tonnes per skate. Designed with an endless hardened roller chain which revolves around the skate. At least 5 rollers remain in contact with the floor at any one time, ensuring smooth travel even over cracked concrete floors. With a range of turntables, stabilisers, spacer bars and steering handles available, Hi-Force skates can move and position heavy and irregular shaped loads easily and more economically than other lifting devices. Hi-Force skates are also ideal for use in confined spaces. Typical applications include bridge building, oil rig installation, transformers, generators, turbines, heavy machinery and many others.

Complete kits :

Model number	Cap. per set tonnes	Skates Qty: 4	Turntables Qty: 2	Stabilisers Qty: 2	Spacer bars Qty: 4	Handles Qty: 2	Wooden box Qty: 1	Weight kg
RSC20	20	RSS20	RT20	RS20	RB20	RH20	WB1	41
RSC50	50	RSS50	RT50	RS50	RB50	RH50	WB2	94

Individual skate selection chart :

Model number	Cap. per skate tonnes	Weight kg
RSS20	5.0	4.0
RSS50	12.5	11.0
RSS100	25.0	27.0
RSS150	37.5	42.0

Length	Width	Dimensions in mm		Roller width	Roller dia
		Height less t/table	Height incl. t/table		
210	102	59	94	51	18
271	125	95	143	87	30
370	175	130	179	90	42
502	186	152	206	90	42

Note : Turntables for RSS100 (RT100) and RSS150 (RT150) are available on request.

RSH - HEAVY DUTY SKATES

The RSH heavy duty range of moving skates are ideal for movement of heavy loads such as transformers, generators, turbines and machinery. Available with capacities ranging from 15 to 100 tonnes each skate.

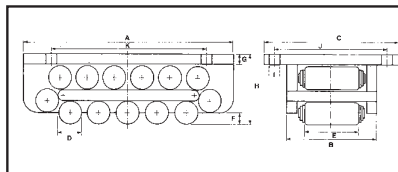

Model number	Capacity tonnes	Rollers in contact	Rollers total	Weight kg
RSH15	15	5	15	9
RSH20	20	4	13	12
RSH40	40	4	13	19
RSH50	50	6	17	29
RSH65	65	4	13	51
RSH100	100	6	17	92

Dimensions in mm										
A	B	C	D	E	F	G	H	I	J	K
210	100	175	18	51	6	13	76	14	140	150
220	113	190	24	60	10	14	87	14	155	150
270	130	210	30	68	10	14	104	18	175	190
320	140	220	30	68	10	18	115	18	180	240
380	168	270	42	76	19	19	145	22	220	280
530	182	300	50	86	19	19	165	22	240	410

REX & RSX - HEAVY DUTY SKATES WITH GROOVED GUIDE



Capacities from 40 to 400 tonnes

Heat treated load bearing centre plate

Heat treated, special chrome alloy chains

The REX heavy duty range of single roller moving skates incorporates a chain groove cut into the centre member of the skate, which helps to keep the chain running parallel with the body and is specially suited for moving loads over long distances. Available with capacities up to 200 tonnes each skate.

The RSX range offers the same features, however has a double roller design, capable of transporting loads up to 400 tonnes per skate.

All models feature high quality, heat treated components and are supplied with 4 mounting bolt holes for easy attachment to the load.

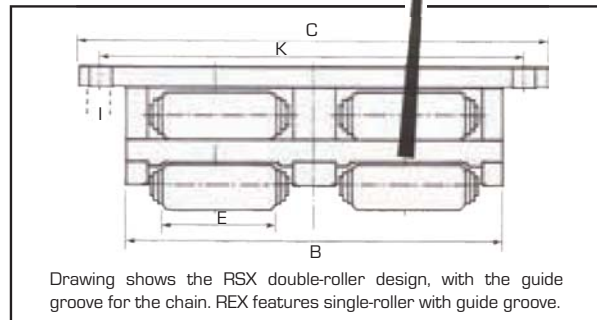
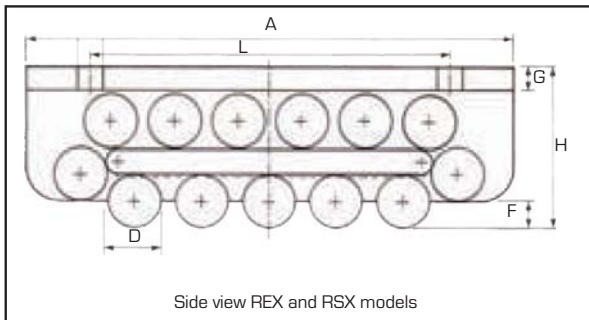
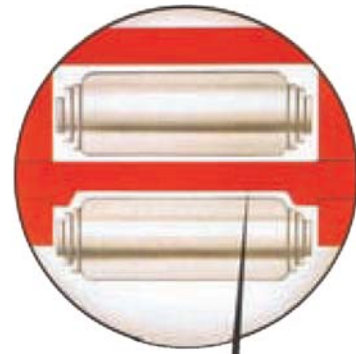

H

Model number	Capacity tonnes	Rollers in contact	Rollers total	Weight kg
REX Range - Single-roller design				
REX40	40	4	13	20
REX50	50	6	17	29
REX65	65	4	13	52
REX100	100	6	17	93
REX150	150	9	23	162
REX200	200	13	31	266
RSX Range - Double-roller design				
RSX80	80	2 x 4	2 x 13	36
RSX100	100	2 x 6	2 x 17	57
RSX130	130	2 x 4	2 x 13	96
RSX200	200	2 x 6	2 x 17	175
RSX300	300	2 x 9	2 x 23	305
RSX400	400	2 x 13	2 x 31	485

Dimensions in mm										
A	B	C	D	E	F	G	H	I	K	L
270	130	210	30	68	10	14	104	18	175	190
320	140	220	30	68	10	18	115	18	180	240
380	168	270	42	76	19	19	145	22	220	280
530	182	300	50	86	19	19	165	22	240	410
600	205	350	50	100	20	28	190	26	280	480
900	205	380	50	100	20	38	200	33	300	720
270	260	340	30	68	10	14	104	18	305	190
320	280	360	30	68	10	18	115	18	325	240
380	336	440	42	76	19	19	145	22	390	300
530	364	480	50	86	19	19	165	22	430	420
600	410	560	50	100	20	28	190	26	490	480
900	410	590	50	100	20	38	200	33	500	720